



At the intersection of
trade shows, meetings
and *hospitality*

World Equestrian Center – Ocala offers a rare combination of quality and capacity. This world-class destination is home to multiple exposition centers and climate-controlled arenas with over 700,000 square feet of flexible indoor space. In addition, current and future expansion of outdoor capacity includes spacious fields to accommodate a variety of pop culture, social and athletic events.

Quality. Class. Distinction.®



WORLD
EQUESTRIAN CENTER®
OCALA, FL

MAP OF FACILITY

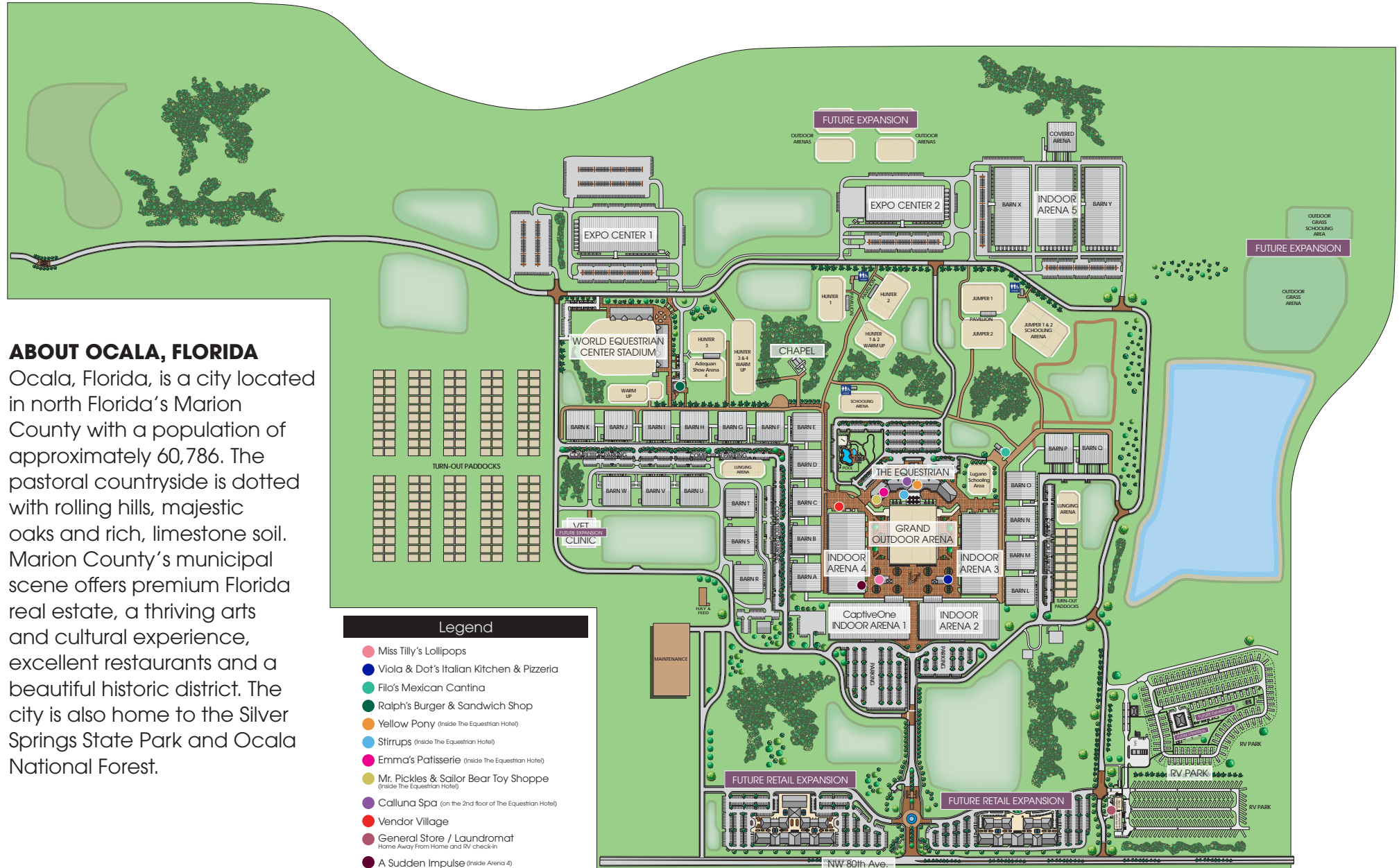



World Equestrian Center – Ocala FACT SHEET

World Equestrian Center – Ocala boasts ample outdoor and indoor, climate-controlled event space for competition and recreation. This multidisciplinary facility provides several venues for numerous events with accommodations, luxury amenities and dining options conveniently located throughout property.

THE EQUESTRIAN HOTEL

- Floors: 5
- Rooms: 248
- Handicapped-accessible: 67
- Check-in: 4pm
- Checkout: 12pm

RV PARK

- 280 RV Slips
- Water, power and sewer hookups provided at each slip
- General Store and Fuel Station
- Shower facilities and Laundromat

HOME AWAY FROM HOME

- 70 Units
- 3 Bedroom / 2 Bathroom
- Full Kitchen and Dining Area
- Sleeper Sofa
- Washer and Dryer

EVENT SPACE

- Exposition Center 1 – Contiguous, column-free space, 2 LED Walls and 1 Four-sided LED Screen
- Exposition Center 2 – Contiguous, column-free space, 2 LED Walls and 1 Four-sided LED Screen
- Arenas 1-4 – 1 LED Wall and 2 LED center displays
- Arena 5 – 2 LED Walls and 1 Four-sided LED Screen
- Grand Outdoor Arena – Connected to The Equestrian Hotel, open-air stadium for 1,500 spectators with 2 LED Walls
- World Equestrian Center Stadium – Open-air stadium for 7,000 spectators with 1 LED Wall

EVENT FEATURES & SERVICES

- Dedicated loading dock at each Exposition Center
- Multiple freight doors at each Exposition Center
- Dedicated Event Management team
- On-site AV production
- On-site IT team
- Convenient on-site parking

AMENITIES AND ENHANCEMENTS

- Business Centers located on the 3rd and 5th floor of The Equestrian Hotel
- On-site Printing Service
- In-Room Dining:

RECREATIONAL FACILITIES

- Outdoor Pool and Splash Park
- Walking/jogging path
- Salon and Spa
- 24-hour fitness center
- Sand volleyball court

RESTAURANTS (include indoor and outdoor seating)

- Emma's Patisserie
- Filo's Mexican Cantina
- Yellow Pony: Horse to Water Pool & Bar
- Miss Tilly's Lollipops
- Ralph's Burger & Sandwich Shop
- Stirrups Restaurant
- Viola & Dot's Italian Kitchen & Pizzeria
- Yellow Pony Pub & Garden



DINING

HOTEL DINING

EMMA'S PATISSERIE

A blissful, freshly baked array of authentic French macarons, European-inspired pastries and gourmet coffees are served within an ambiance of old-world elegance at this very special shop located within The Equestrian Hotel.

HORSE TO WATER

As part of the hotel's outdoor recreation, guests are welcome to visit the Horse to Water Pool & Bar for a meal and some fun. Perfect for the whole family, children can enjoy the animal-inspired splash pad while adults cool off with a cocktail or refresh in the zero-entry pool. The Horse to Water Pool & Bar presents a great opportunity to lounge beneath the warm Florida sun and enjoy quintessential poolside food.

STIRRUPS RESTAURANT

Prime steaks and chops, sustainable Florida seafood and southern-inspired seasonal specialties are served in a refined dining room and terrace overlooking the Grand Outdoor Arena. Stirrups Restaurant, located inside of The Equestrian Hotel, is poised to be Ocala's premier steakhouse.

YELLOW PONY PUB & GARDEN

Yellow Pony Pub & Garden offers an authentic, pub dining experience with live music and a host of shareable appetizers and entrees. Additionally, the bar menu includes an impressive collection of bourbon, whiskey and specialty cocktails.

IN-ROOM DINING: THE EQUESTRIAN HOTEL

Enjoy fresh food and beverages delivered to your suite, courtesy of the hospitality team. We offer a custom menu selection with made-to-order cuisine to cater to your specific tastes.

OTHER DINING

FILO'S MEXICAN CANTINA

Traditional Mexican flavors coupled with custom-made convenience make Filo's the perfect spot for all-day dining, including breakfast. Filo's serves up street tacos, burritos, quesadillas and much more in a vibrant dining room and open-air patio.

MISS TILLY'S LOLLIPOPS

Indulging is strongly encouraged at this unique sweet shop where specialty ice cream flavors and homemade fudge are the stars. With an array of chocolates, confections and coffees, Miss Tilly's is the perfect place for a tasty treat.

RALPH'S BURGER & SANDWICH SHOP

Home to a classic Americana, diner-inspired menu, Ralph's invites you to enjoy signature burgers, salads and sandwiches topped off with a homemade milkshake. Open for breakfast, lunch and dinner, start your day with a breakfast sandwich or enjoy an evening slice of pie.

VIOLA & DOT'S ITALIAN KITCHEN & PIZZERIA

Design your own flatbread, salad or pasta masterpiece with an assortment of delicious meats and toppings. Viola & Dot's features pizzas and calzones crafted with homemade dough, classic Italian entrees and decadent sweet desserts.



Scan the QR Code to go directly to our dining web page or visit: wec.net/ocala-fl/visit/dining/



WORLD
EQUESTRIAN CENTER[®]
OCALA, FL

DINING MAP





AMENITIES

THE EQUESTRIAN HOTEL

The world-class hotel boasts 248 well-appointed guest suites in addition to a state-of-the-art fitness center, salon and day spa, outdoor swimming pool and multiple walking trails.

RETAIL

The multilevel, design-driven shops offer nearly 13,000 square feet of prestigious brand names in fashion, beauty, décor and cuisine all within The Equestrian Hotel. These high-end boutiques cater to every lifestyle while combining exquisite commodities with a luxurious experience.

Future development will boast large shopping plazas located adjacent to the World Equestrian Center main entrance.

SALON & SPA

Located on the second floor, the Calluna Spa is World Equestrian Center – Ocala's luxurious salon and day spa. This retreat offers numerous amenities for relaxation, as well as a customizable spa menu. Massages, hair stylings, facials, manicures, pedicures and body treatments represent just some of the many services available at the Calluna Spa.

- 5 massage rooms
- Couple's massage room
- Full-service salon

CHAPEL

The serene, on-site chapel, located in an oak-canopy forest, offers daily opportunities for prayer, peace and reflection.

- Seats up to 100 guests
- Surrounded by beautiful, lush gardens
- Accommodates small weddings and intimate ceremonies

OTHER AMENITIES

- Golf cart rental
- Sand volleyball court





SHOP at World Equestrian Center – Ocala

World Equestrian Center – Ocala offers world-class equestrian living with access to prestigious designers, fashion, beauty, décor and cuisine.

LUGANO DIAMONDS

World Equestrian Center – Ocala Founding Partner, Lugano Diamonds, brings some of the rarest and most precious gems to life through exquisite, one-of-a-kind wearable works of art.

EXCEPTIONAL EQUESTRIAN

This lifestyle boutique specializes in absolutely nothing you need, just everything you want! Offering apparel, equipment and accessories from the premium brands of equestrian sport.



A SUDDEN IMPULSE

Whether shopping for yourself, a fellow equestrian or a friend, you're sure to find something unique at A Sudden Impulse. The boutique features a collection of fine jewelry, beautiful apparel and luxurious gifts, plus, custom embroidery, engraving and printing.

AGM LEATHER

AGM Leather makes quality accessible. Handcrafted Columbian leather products by AGM provide long-lasting sophistication, with every detail thoughtfully designed in order to achieve the perfect balance of simplicity and elegance.

MR. PICKLES & SAILOR BEAR TOY SHOPPE

Mr. Pickles & Sailor Bear Toy Shoppe represents another luxury retail establishment, the shelves are stocked with vast collection of private-labeled toys, such as Breyer Horses.

HAALA DENIM

Known for classic style, symmetry and modern branding, HAALA Denim includes fashion and performance apparel created with the perfect fit as a top priority. Unique stretch blend is a spotlight for the brand that utilizes industry leading sewing professionals, pattern makers, wash facilities and finishing teams.



ARIAT INTERNATIONAL

Founded as "The New Breed of Boot" Ariat International was the first to integrate athletic footwear technology into boots for equestrian athletes. Ariat offers a carefully curated assortment of footwear, apparel, denim and accessories.

VENDORS AT WORLD EQUESTRIAN CENTER – OCALA

Vendors offer a collection of carefully curated items such as equestrian equipment, supplements and treats, clothing for in and out of the show ring, accessories, tack trunks, specialty foods and home goods.

I LOVE MY HORSE EQUESTRIAN BOUTIQUE

From the barn, to the LQ, to the house, both rider and horse will approve of these hand-picked, gorgeous essentials. All products are created or selected with passion, adventure and a little humor in mind!

THE DEBONAIR COLLECTION

The luxury boutique and home accessories store offers specially sourced, authentic merchandise from all over the world. Includes leather goods, appeal, home accessories and custom furniture.

PARLANTI BOOTS

Parlanti International specializes in luxury riding wear and fashion apparel. Envied by many competing brands for decades, none have been able to match the quality, innovation and seamless fit which maintain their illustrious reputation.





INDOOR FACILITY SPECS

Specifications, Features & Amenities	Expo 1	Expo 2	Arena 1	Arena 2	Arena 3	Arena 4	Arena 5
Dimensions	540' x 245'	540' x 245'	530' x 170'	530' x 170'	530' x 170'	530' x 170'	474' x 160'
Square Feet	132,300	132,300	90,630	90,630	90,630	90,630	75,840
Permanent Seats			1,326	1,326	1,326	1,326	3,400
Ceiling Height	Low-14' High-45'	Low-14' High-45'	Low-18' High-35'	Low-18' High-35'	Low-18' High-35'	Low-18' High-35'	Low-14' High-45'
Load-In/Load-Out	(1) Dedicated Dock Slip (4) 20' x 20' Freight Doors (5) 16' x 18' Freight Doors	(1) Dedicated Dock Slip (13) 20' x 20' Freight Doors (5) 16' x 18' Freight Doors	(3) 20' x 20' Freight Doors	(3) 20' x 20' Freight Doors	(3) 20' x 20' Freight Doors	(3) 20' x 20' Freight Doors	(6) 20' x 20' Freight Doors (5) 16' x 18' Freight Doors
Floor Finish	Carpet	Concrete	GGT Footing	GGT Footing	GGT Footing	GGT Footing	Sand/Clay
Floor Parts	22 per hall	22 per hall					
Climate Controlled	✓	✓	✓	✓	✓	✓	✓
Column Free	✓	✓	✓	✓	✓	✓	✓
Announcer/Judges Booth			✓	✓	✓	✓	✓
Mezzanine VIP Suites			✓	✓	✓	✓	
Electricity Phase	Phase 1 & 3 Floor Parts	Phase 1 & 3 Floor Parts					
Internet High-Speed Wi-Fi	✓	✓	✓	✓	✓	✓	✓
LED Walls	(2) 38' x 22' Resolution 2944x1662	(2) 38' x 22' Resolution 2944x1662	(1) 38' x 22' Resolution 2240x1288	(1) 38' x 22' Resolution 2240x1288	(1) 38' x 22' Resolution 2240x1288	(1) 38' x 22' Resolution 2240x1288	(2) 38' x 22' Resolution 2944x1662
LED Center Displays	(1) 4-sided 16' x 9' Resolution 1152 x 648	(1) 4-sided 16' x 9' Resolution 1152 x 648	(2) 25' x 15' Resolution 1920 x 1152	(2) 25' x 15' Resolution 1920 x 1152	(2) 25' x 15' Resolution 1920 x 1152	(2) 25' x 15' Resolution 1920 x 1152	(1) 4-sided 16' x 9' Resolution 1152 x 648
Lighting Programmable LED	✓	✓					
Food Service/Catering	(2) Concession Stands Catering Service	(2) Concession Stands Catering Service	Catering Service	Catering Service	Catering Service	Catering Service	(2) Concession Stands Catering Service
Foyer for Event Registration	✓	✓	✓	✓	✓	✓	✓
Show Office(s)	(1) 31' x 12' x 10' (1) 15' x 12' x 10'	(1) 31' x 12' x 10' (1) 15' x 12' x 10'	(2) Level 2	(2) Level 2	(2) Level 2	(2) Level 2	(1) 31' x 12' x 10' (1) 15' x 12' x 10'
On-Site Parking	✓	✓	✓	✓	✓	✓	✓
Restrooms	✓	✓	✓	✓	✓	✓	✓

OUTDOOR FACILITY SPECS



Specifications, Features & Amenities	WORLD EQUESTRIAN CENTER STADIUM	GRAND OUTDOOR ARENA
Dimensions	370' x 370'	380' x 300'
Square Feet	136,900	114,000
Permanent Seats	7,000	1,500
Floor Finish	GGT Footing	GGT Footing
Announcer/Judges Booth	✓	✓
Internet High-Speed Wi-Fi	✓	✓
LED Walls	(1) 38' x 22' Resolution 2240x1288	(2) 38' x 22' Resolution 2240x1288
Food Service/Catering	(4) Concession Stands Catering Service	Catering Service
Show Office(s)	(4)	
On-Site Parking	✓	✓
Restrooms	✓	✓



INDOOR EXPO 1

SPECIFICATIONS	
Dimensions	540' x 245'
Square Feet	132,300
Foyer	74' x 50'
Show Office 1	31' x 12' x 10'
Show Office 2	15' x 12' x 10'
Load-In / Load-Out Capacity	(1) Dedicated Dock Slip (4) 20' x 20' Freight Doors (5) 16' x 18' Freight Doors
Ceiling Height	Low – 14' High – 45"
Floor Ports	22 per hall
Electricity	Phase 1 & 3 Floor Ports
Infrastructure & Technology	(2) LED Center Displays 38' x 22' Resolution: 2944 x 1662 (1) 4-sided LED Center Display 16' x 9' Resolution: 1152 x 648 LED Lighting Internet High-Speed Wi-Fi
Food Service	(2) Built-In Concession Stands Catering Services
Features & Amenities	On-Site Parking – 456 Handicapped-accessible – 12 Adjacent Lot – 400 Carpet / Column-free

Tradeshows • Social Events • Concerts • Car Shows
Canine Events • Conferences • Sporting Events

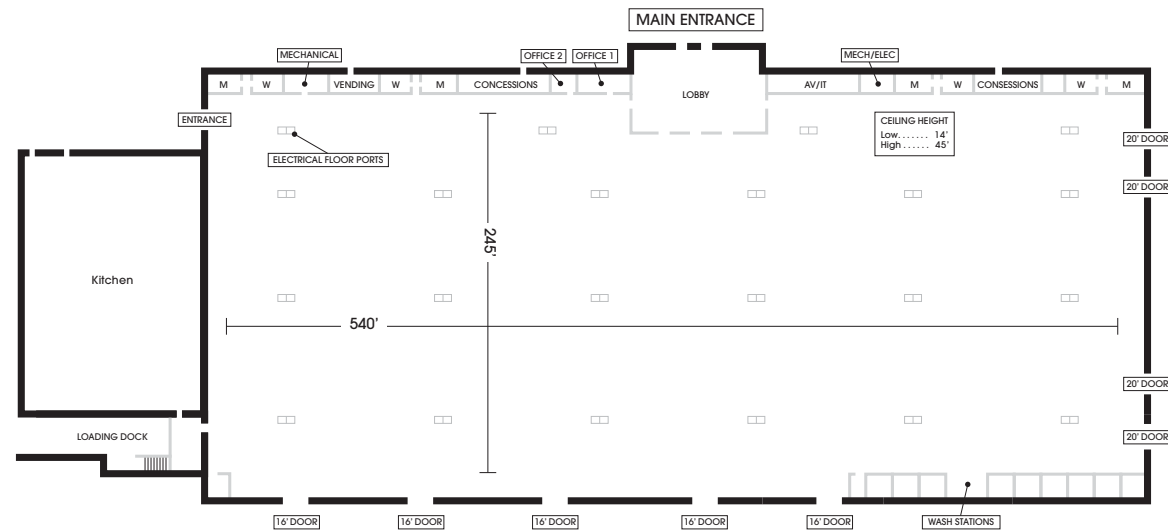

INDOOR EXPO 2



SPECIFICATIONS	
Dimensions	540' x 245'
Square Feet	132,300
Foyer	74' x 50'
Show Office 1	31' x 12' x 10'
Show Office 2	15' x 12' x 10'
Load-In / Load-Out Capacity	(1) Dedicated Dock Slip (13) 20' x 20' Freight Doors (5) 16' x 18' Freight Doors
Ceiling Height	Low – 14' High – 45'
Floor Ports	22 per hall
Electricity	Phase 1 & 3 Floor Ports
Infrastructure & Technology	(2) LED Center Displays 38' x 22' Resolution: 2944 x 1662 (1) 4-sided LED Center Display 16' x 9' Resolution: 1152 x 648 LED Lighting Internet High-Speed Wi-Fi
Food Service	(2) Built-In Concession Stands Catering Services
Features & Amenities	On-Site Parking – 256 Handicapped-accessible – 8 Concrete / Column-free

Tradeshows • Social Events • Concerts • Car Shows
Canine Events • Conferences • Sporting Events

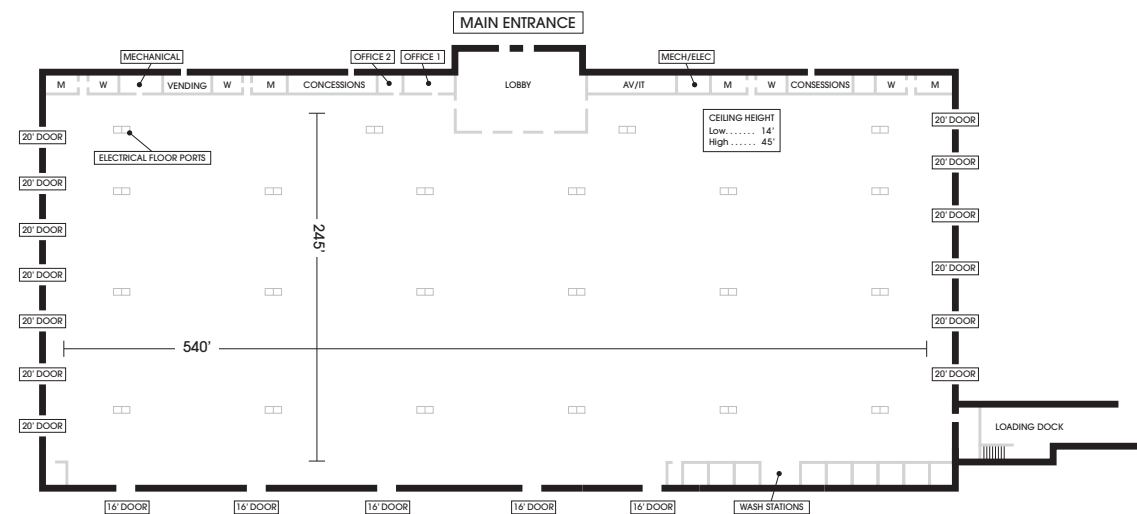



INDOOR ARENA 1

SPECIFICATIONS	
Dimensions	530' x 170'
Square Feet	90,630
Load-In / Load-Out Capacity	(3) 20' x 20' Freight Doors
Ceiling Height	Low – 18' High – 35'
Permanent Seats	1,326
Floor Finish	GGT Footing
Mezzanine VIP Suites	Exclusive
Infrastructure & Technology	(1) LED End Wall Display 38' x 22' Resolution: 2240 x 1288 (2) LED Center Displays 25' x 15' Resolution: 1920 x 1152 LED Lighting High-Speed Wi-Fi
Vendor Space	147' 7" x 25'
Judge's Room	17' 7" x 13' 8"
Announcer's Room	18' 2" x 13' 8"
Food Service	Mezzanine VIP Catering
Other Amenities	Connected Barns via covered walkway On-Site Parking

Equine Events • Canine Events • Mezzanine VIP Suites – Meetings and Dinner Functions

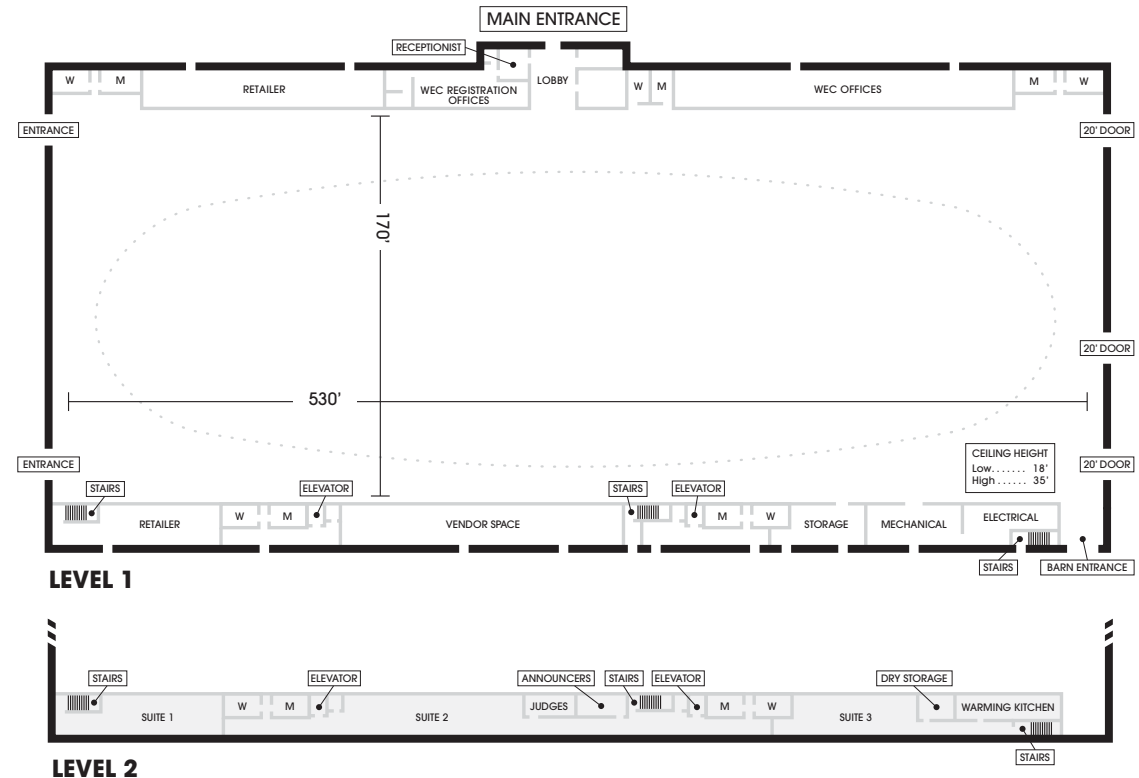

Mezzanine	Suite 1	Suite 2	Suite 3
Dimensions	61.5' x 21.3'	98.9' x 21.3'	64.3' x 21.3'
Square Feet	1,309	2,106	1,369
Rounds	80	112	N/A
Reception	100	150	30
Theater	140	210	N/A
Classroom	54	80	N/A

INDOOR ARENA 2



SPECIFICATIONS	
Dimensions	530' x 170'
Square Feet	90,630
Load-In / Load-Out Capacity	(3) 20' x 20' Freight Doors
Ceiling Height	Low – 18' High – 35'
Permanent Seats	1,326
Floor Finish	GGT Footing
Mezzanine VIP Suites	Exclusive
Infrastructure & Technology	(1) LED End Wall Display 38' x 22' Resolution: 2240 x 1288
	(2) LED Center Displays 25' x 15' Resolution: 1920 x 1152
	LED Lighting
	High-Speed Wi-Fi
Vendor Space	168 x 20'
Judge's Room	136' x 20'
Announcer's Room	17' 10" x 13' 8"
Food Service	Mezzanine VIP Catering
Other Amenities	Connected Barns via covered walkway On-Site Parking

Equine Events • Canine Events • Mezzanine VIP Suites –
Meetings and Dinner Functions

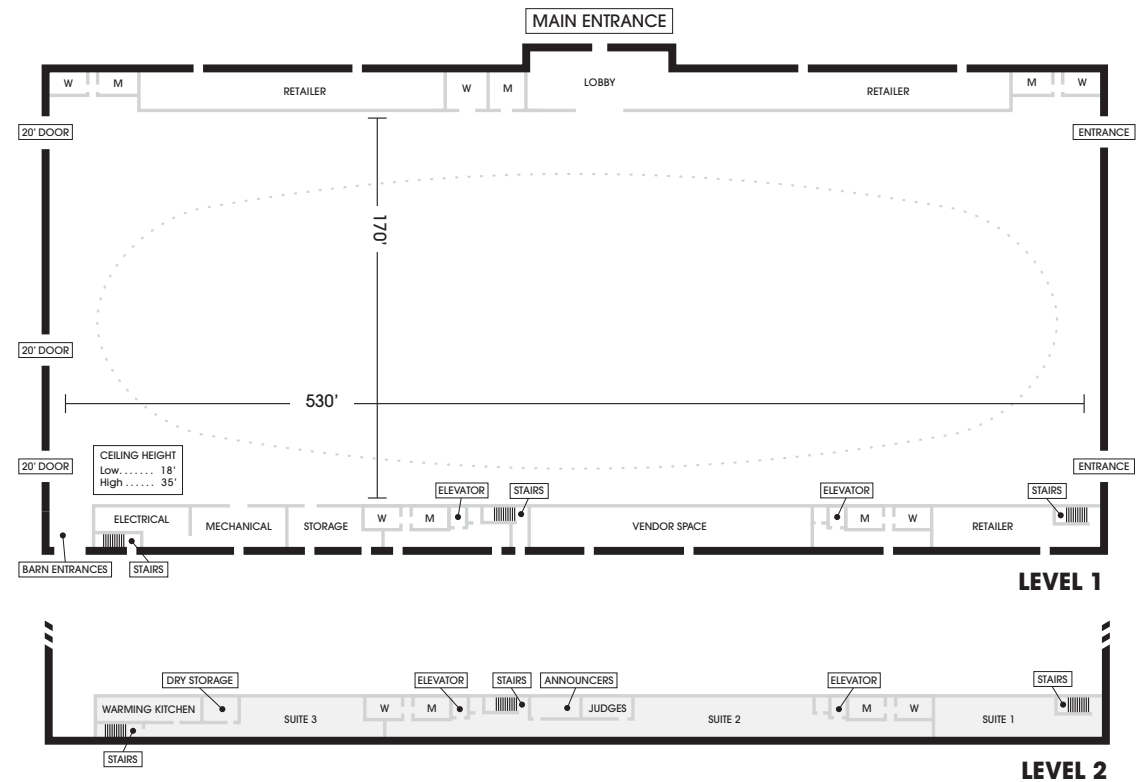

Mezzanine	Suite 1	Suite 2	Suite 3
Dimensions	61.5' x 21.9'	99' x 21.9'	64.9' x 21.9'
Square Feet	1,423	2,168	1,421
Rounds	N/A	152	96
Reception	30	175	120
Theater	N/A	240	160
Classroom	N/A	90	60



INDOOR ARENA 3

SPECIFICATIONS	
Dimensions	530' x 170'
Square Feet	90,630
Load-In / Load-Out Capacity	(3) 20' x 20' Freight Doors
Ceiling Height	Low – 18' High – 35'
Permanent Seats	1,326
Floor Finish	GGT Footing
Mezzanine VIP Suites	Exclusive
Infrastructure & Technology	(1) LED End Wall Display 38' x 22' Resolution: 2240 x 1288 (2) LED Center Displays 25' x 15' Resolution: 1920 x 1152 LED Lighting High-Speed Wi-Fi
Vendor Space 1	160' 6" x 20'
Vendor Space 2	251' 6" x 20'
Judge's Room	17' 10" x 13' 8"
Announcer's Room	18' 4" x 13' 8"
Food Service	Mezzanine VIP Catering
Other Amenities	Connected Barns via covered walkway On-Site Parking

Equine Events • Canine Events • Mezzanine VIP Suites – Meetings and Dinner Functions

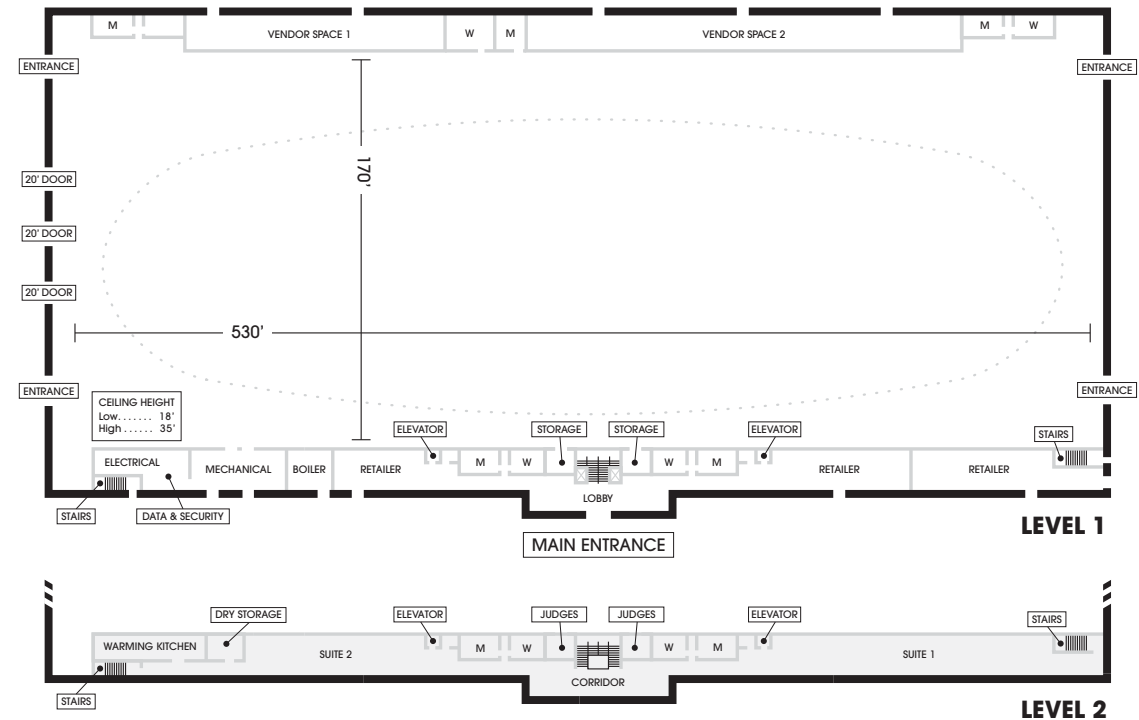

Mezzanine	Suite 1	Suite 2
Dimensions	99.2' x 21.3'	147.9' x 21.8'
Square Feet	2,162	3,224
Rounds	96	224
Reception	113	250
Theater	N/A	360
Classroom	N/A	135

INDOOR ARENA 4



SPECIFICATIONS	
Dimensions	530' x 170'
Square Feet	90,630
Load-In / Load-Out Capacity	(3) 20' x 20' Freight Doors
Ceiling Height	Low – 18' High – 35'
Permanent Seats	1,326
Floor Finish	GGT Footing
Mezzanine VIP Suites	Exclusive
Infrastructure & Technology	(1) LED End Wall Display 38' x 22' Resolution: 2240 x 1288
	(2) LED Center Displays 25' x 15' Resolution: 1920 x 1152
	LED Lighting
	High-Speed Wi-Fi
Vendor Space 1	168' x 20'
Vendor Space 2	136' x 20'
Judge's Room	17' 10" x 13' 8"
Announcer's Room	18' 4" x 13' 8"
Food Service	Mezzanine VIP Catering
Other Amenities	Connected Barns via covered walkway On-Site Parking

Equine Events • Canine Events • Mezzanine VIP Suites – Meetings and Dinner Functions

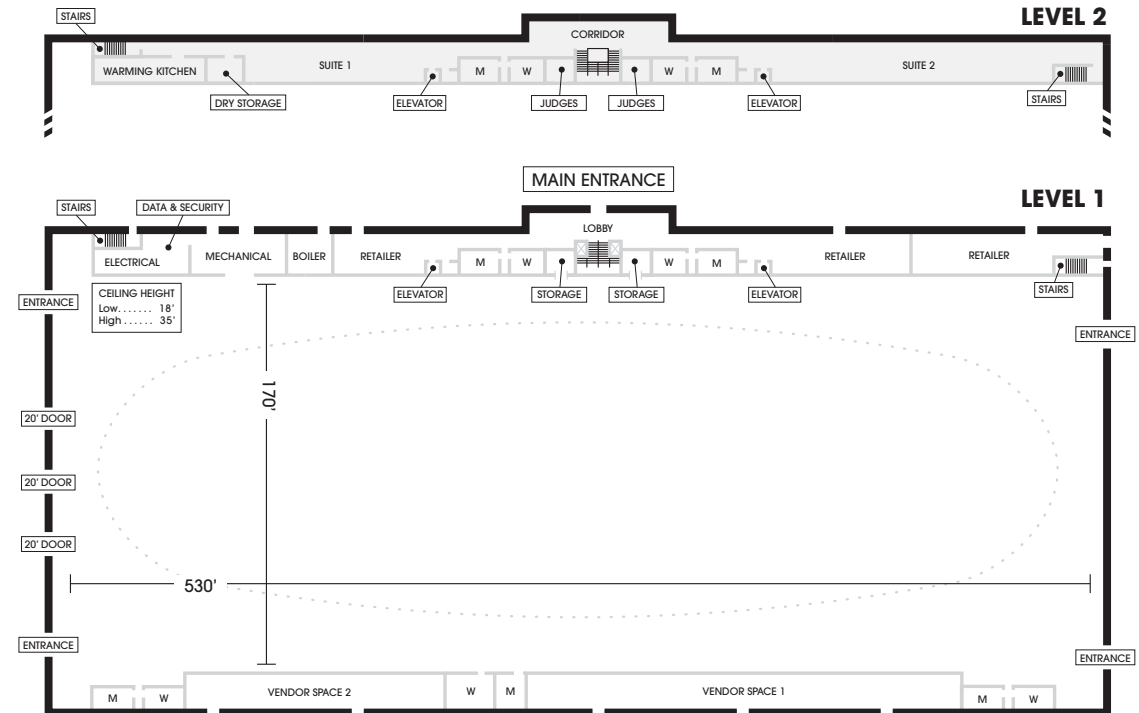

Mezzanine	Suite 1	Suite 2
Dimensions	149.7' x 21.8'	99.3' x 21.8'
Square Feet	3,263	2,164
Rounds	208	168
Reception	225	190
Theater	340	N/A
Classroom	130	N/A



INDOOR ARENA 5

SPECIFICATIONS	
Dimensions	474' x 160'
Square Feet	75,840
Load-In / Load-Out Capacity	(6) 20' x 20' Freight Doors (5) 16' x 18' Freight Doors
Ceiling Height	Low – 14' High – 45'
Permanent Seats	3,400
Floor Finish	Sand/Clay
Infrastructure & Technology	(1) LED End Wall Display 38' x 22' Resolution: 2240 x 1288 (2) LED Center Displays 25' x 15' Resolution: 1920 x 1152 LED Lighting High-Speed Wi-Fi
Foyer	75' x 23'
Show Office 1	31' x 12' x 10'
Show Office 2	15' x 12' x 10'
Announcer/Judge's Room	20' x 40'
Food Service	VIP Catering
Other Amenities	Covered Outdoor Practice Arena On-Site Parking – 655 Handicapped-Accessible – 23 Trailer Parking – 27 Grass Parking – 73

Equine Events • Canine Events • Concerts •
Sporting Events

Located across from lobby entrance

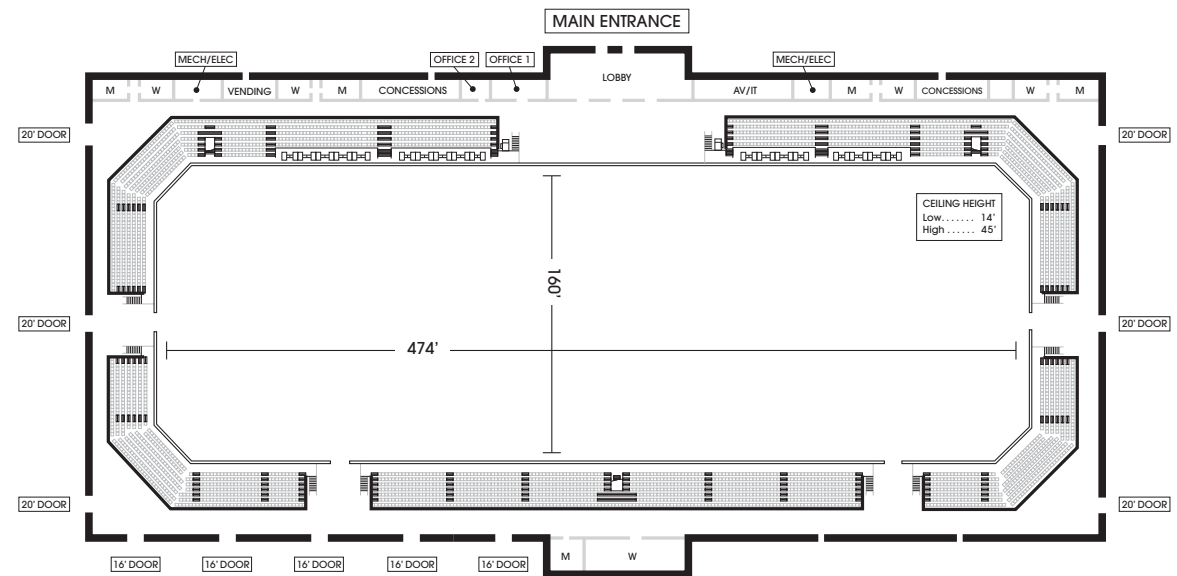

OUTDOOR WORLD EQUESTRIAN CENTER STADIUM



SPECIFICATIONS	
Dimensions	474' x 160'
Square Feet	75,840
Load-In / Load-Out Capacity	16' Entrance Gate
Permanent Seats	7,000
Floor Finish	GGT Footing
Announcer's Room	20' x 24'
Press Box	10' x 24' North 10' x 24' South
Infrastructure & Technology	(1) LED End Wall Display 38' x 22' Resolution: 2240 x 1288 Stadium Lights High-Speed Wi-Fi
Show Office – North 1	34' x 15'
Show Office – North 2	34' x 15'
Show Office – South 1	34' x 15'
Show Office – South 2	34' x 15'
Food Service	Concession Stands Catering Services
Other Amenities	On-Site Parking – 39 Handicap-accessible – 26 Adjacent Lot - 362 (Expo 1 – 6HC – Front & Back) Trailer Parking – 390 Cars or 100 Trailers Grass Parking – 400 Cars

Equine Events • Canine Events • Mezzanine VIP Suites – Meetings and Dinner Functions

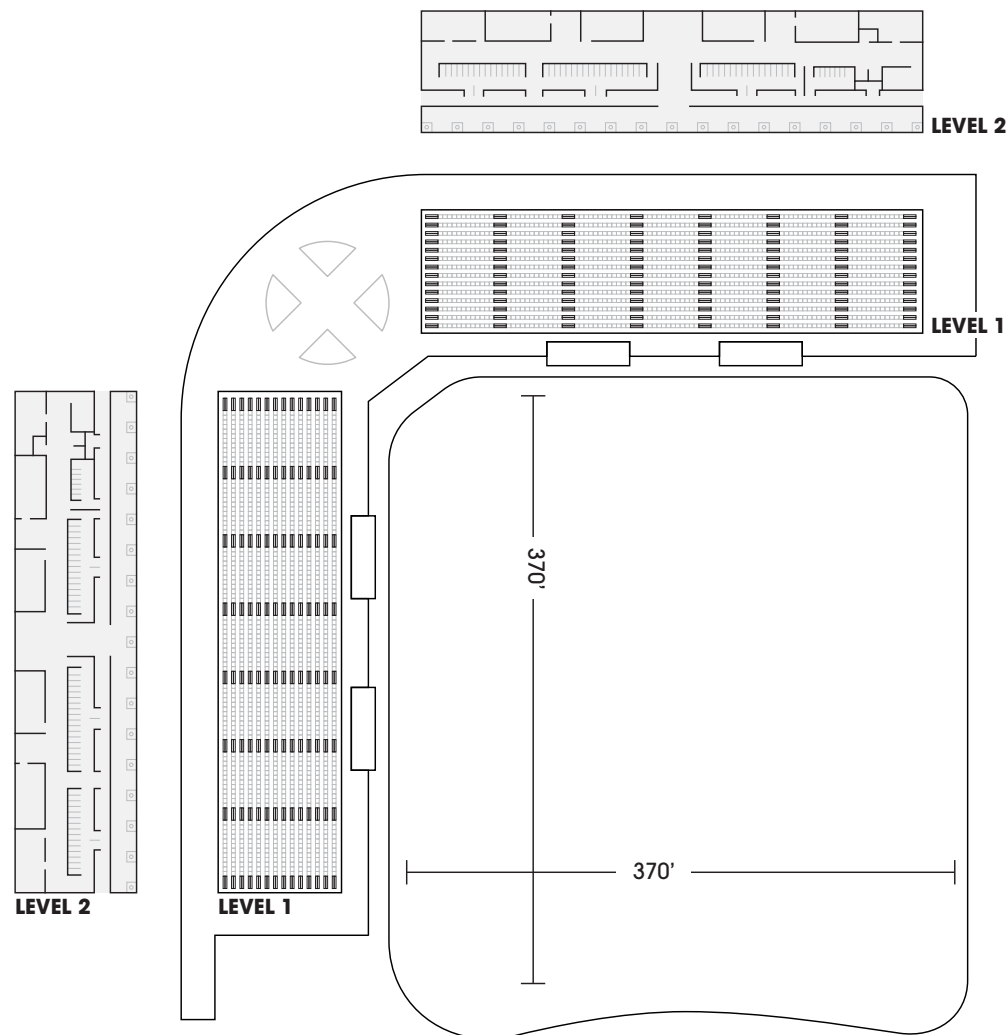



OUTDOOR GRAND OUTDOOR ARENA

SPECIFICATIONS	
Dimensions	474' x 160'
Square Feet	75,840
Load-In / Load-Out Capacity	Two Ramps
Permanent Seats	7,000
Floor Finish	GGT Footing
Announcer's Room	20' x 24'
Infrastructure & Technology	(1) LED End Wall Display 38' x 22' Resolution: 2240 x 1288 Stadium Lights High-Speed Wi-Fi
Food Service	Concession Stands
Other Amenities	On-Site Parking – 562 (Arena 1-412 & Arena 2-150) Handicap-accessible – 16 Grass Parking – 400 Cars

Equine Events • Canine Events • Concerts

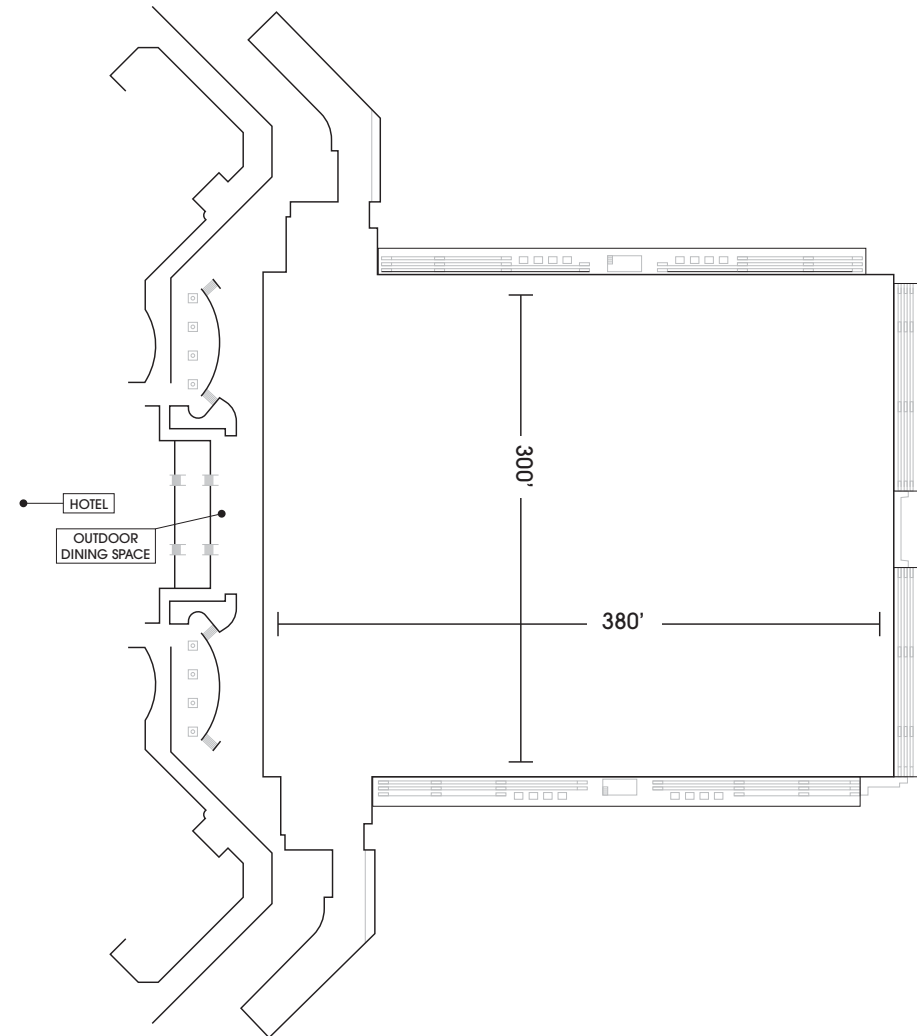





Home to the world's largest and most prestigious equestrian facility, this exclusive property, with mixed-use capacity, is a one-of-a-kind event destination. With continuous expansion on over 378 acres of land, World Equestrian Center – Ocala can host year-round events spanning several vocations, industries and disciplines.

For more information on hosting your next event at World Equestrian Center – Ocala, contact:

Rodney Gutierrez, CMP **Director of Sales**

Office: 352.414.7850 ocalasales@wec.net

